

REGULATOR MODULE

R271X1-XXX

RELEASED: 1-21-00
REVISED:
(REV.)

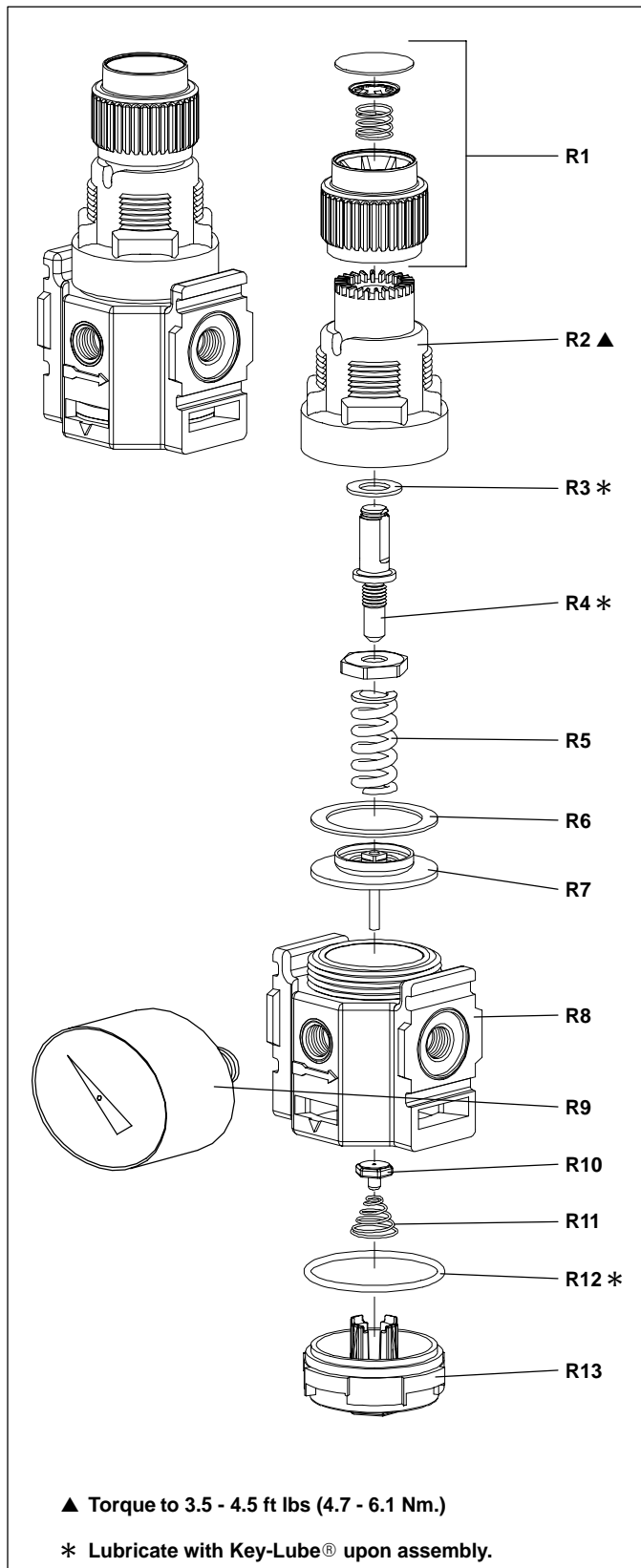

TECHNICAL SPECIFICATIONS

MATERIALS OF CONSTRUCTION

Body: Glass reinforced nylon.

Seals: Nitrile.

Diaphragm: Nitrile.

Valve: Nylon and Nitrile.

Housing: Glass reinforced nylon.

OPERATION CONDITIONS

Temperature Range: 0° to 150° F (-18° to 66° C).

Max. Inlet Air Pressure: 200 p.s.i.g. (13.8 bar).

Application: Industrial compressed air systems.

Flow: Air flow is at 125 p.s.i.g. (8.6 bar) inlet and 100 p.s.i.g. (6.9 bar) outlet.

1/8" - 13 scfm (6 dm³/s)

1/4" - 13 scfm (6 dm³/s)

PARTS LIST

ITEM	DESCRIPTION (SIZE) [INCLUDES]	QTY	PART NO.
R1	Knob (standard)	(1)	N / A
	(tamper - resistant kit)	(1)	104109
R2	Housing (torque to 3.5 - 4.5 ft lbs)	(1)	N / A
R3	Washer	(1)	N / A
R4	Adjustment Screw	(1)	N / A
R5	Spring (Black, 0 - 15 lb.)	(1)	29622
	(Blue, 0 - 25 lb.)	(1)	29754-1
	(Olive, 0 - 50 lb.)	(1)	29540
	(Gold, 5 - 125 lb.)	(1)	29539
<input type="checkbox"/> R6	Washer	(1)	29749-1
<input checked="" type="checkbox"/> R7	Diaphragm Assembly (relieving)	(1)	100206-1
	(non-relieving)	(1)	100206-2
R8	Regulator Base	(1)	N / A
R9	Gauge (0 - 14 p.s.i. / 0 - 1.0 bar)	(1)	29846
	(0 - 30 p.s.i. / 0 - 2.1 bar)	(1)	29755-1
	(0 - 60 p.s.i. / 0 - 4.1 bar)	(1)	29863
	(0 - 150 p.s.i. / 0 - 11.0 bar)	(1)	100095-160
<input checked="" type="checkbox"/> R10	Valve Assembly	(1)	29887
<input checked="" type="checkbox"/> R11	Spring	(1)	29659
<input checked="" type="checkbox"/> R12	"O" Ring (1/16" x 1-7/16" o.d.)	(1)	Y325-27
R13	Regulator Plug	(1)	100120
R14	Pipe Plug (1/8 - 27 N.P.T. x .27") (not shown)	(1)	Y17-50
<input checked="" type="checkbox"/>	Items included in Relieving Repair Kit	(1)	104255
<input type="checkbox"/>	Items included in Non-Relieving Repair Kit	(1)	104256

Key-Lube® is a registered trademark of Key Industries.

ARO

INGERSOLL-RAND COMPANY
P.O. BOX 151 • ONE ARO CENTER • BRYAN, OHIO 43506-0151
☎ (419) 636-4242 • FAX (419) 633-1674

© 2000 • PRINTED IN U.S.A.

INGERSOLL-RAND
FLUID PRODUCTS

OPERATING AND SAFETY PRECAUTIONS

- Use only genuine ARO replacement parts to assure compatible pressure rating and performance.
- Read carefully all warnings and safety precautions and heed the following before operating, to avoid personal injury and / or property damage.
- Be certain anyone operating this equipment has been trained to use it safely.

⚠ WARNING COMPONENT RUPTURE. DO NOT EXCEED MAXIMUM RATED OPERATING PRESSURE OF 200 p.s.i. (13.8 bar). To avoid possible damage or personal injury, DO NOT expose the unit to excessive pressure beyond the intended working range.

⚠ WARNING TEMPERATURE LIMITS. DO NOT EXCEED MAXIMUM TEMPERATURE LIMITS OF 150° F (66° C). Excessive temperature can affect non-metallic parts which may weaken them and cause failure.

⚠ WARNING USE WITH INDUSTRIAL COMPRESSED AIR SYSTEMS ONLY. DO NOT USE WITH BOTTLED GAS

PRODUCTS OR FLUIDS. MISAPPLICATIONS CAN RESULT IN COMPONENT FAILURE.

⚠ WARNING DISASSEMBLY HAZARD. DO NOT DISASSEMBLE THIS UNIT WHEN IT IS UNDER PRESSURE. SHUT OFF AND RELIEVE AIR SUPPLY BEFORE ATTEMPTING SERVICE OR DISASSEMBLY PROCEDURES. Isolate the unit by closing the line valve or disconnect the supply line or hose.

- **CAUTION:** THE REGULATOR GAUGE PORT SHOULD NOT BE USED AS AN AUXILIARY PRESSURE OUTLET PORT. The gauge port is intended to be used only for pressure monitoring, sensing or remote pilot. The feedback may affect the set pressure.

- **NOTE:** Secondary pressure adjustment ranges are not minimum or maximum secondary pressure limits. Regulators can be adjusted to zero p.s.i.g. secondary pressure and, generally, to pressures in excess of those specified. The use of these regulators to control pressure outside of the specified range is not recommended.

INSTALLATION

- Install regulator with the air flow as indicated by the arrow on the unit.
- Install regulator as close as possible to the air operated equipment for best performance.
- Locate the regulator upstream from the lubricator.
- Regulator can be mounted with the knob up or down.
- If the air line contains water, sludge or foreign materials, a filter should be installed on the upstream side to protect the regulator.
- See gauge port "CAUTION".
- A tamper resistant feature is available to lock in specific air requirements.
- After a regulator has been installed in the air line, the adjustment knob should be turned counterclockwise until compression is released from the pressure control spring. This prevents over pressurizing the air operated equipment when the air supply is turned on.

OPERATION

- Pull knob to adjust air pressure.
 - Turn clockwise to increase pressure.
 - Turn counterclockwise to decrease pressure.
- NOTE: On non-relieving models only, reduce pressure to lower than estimated final operating pressure, purge air (open or actuate air operated equipment to relieve pressure), adjust pressure upward as needed.
- Push to lock

MAINTENANCE

- Once the system has been depressurized, the regulator valve and diaphragm can be replaced without removing the unit from the line.